

No. CI/24636/TC/2012

**Transport Commissionerate, Kerala,**  
2<sup>nd</sup> Floor, Trans Towers, Vazhuthacaud, Thiruvananthapuram-14,  
[☎ 0471-2333337/2333317 FAX 0471-2333314]  
[e-mail - [tcoffice@keralamvd.gov.in](mailto:tcoffice@keralamvd.gov.in) ]  
**Dated, 05-03-2013**

**Circular No. 02/2013**

Sir,

Sub:- Motor Vehicles Department – Driving licence to drive Transport Vehicles – conduct of test – procedures ordered.

Ref:- This office Circular No.20/98 dated 25-07-1998.

The Rule 31 of the Central Motor Vehicles Rules 1989 prescribes the syllabus for imparting instructions in driving of all types of vehicles including Transport vehicles. Rule 15 of the said rule specifies the method of conducting test of competence to drive referred to in section 9 (3) of the Motor Vehicles Act 1988. Circular No.20/98 dated 25-07-1998 has laid out the procedure and specifications for conducting Driving Licence test of Light Motor Vehicles Two wheelers and Three wheelers. But no procedure is specified for conducting test of competence to drive Transport Vehicles including heavy vehicles, till date.

Taking into consideration the ever increasing road accidents and death rate proper training of drivers according to syllabus has to be ensured by specifying procedure for test of competence for transport vehicles including heavy vehicles. Central Motor Vehicles Rule 15 specifies that the test of competence shall be conducted in a vehicle of the type for which the licence application relates (eg. Medium vehicle, Heavy Goods Vehicles, Heavy Passenger Vehicles, Tractor & Tractor, Articulated Vehicles etc.) Hence procedure of conducting test of competence for transport vehicles including heavy vehicles is laid down hereunder.

**Part I – Test sheet**

(The candidate shall demonstrate the following and explain the purpose of each. The testing officer shall tick the items correctly demonstrated by the candidate so as to award the marks.)

A Pre-driving checks (a) Before sitting on the seat

- i. Check Tyres for inflation of air, wear and tear, loose or missing wheel nuts.
- ii. Check Water/Coolant level in radiator, loose or broken fan belt.
- iii. Check engine oil level with dipstick
- iv. Check brake fluid level and Power steering fluid, if applicable
- v. Check battery for acid level, loose or corroded terminals
- vi. Check suspension for loose or broken spring and shock absorbers
- vii. Check emergency equipments – Fire extinguisher, spare tyre, jack and lever, F.A. box, electrical fuses and reflective warning triangles

(b) After sitting on driver's seat

- i. Check air pressure – Brake pedal and hand brake for working condition.
- ii. Check steering and clutch-for excessive play
- iii. Check park lights and head lights for brightness, dim and bright
- iv. Check indicator lights, stop lights, and Hazard lights
- v. Check Interior lights and horn
- vi. Check Windscreen wiper – blades, water/solution
- vii. Take precautions before starting the engine – (Park brake on, gear in neutral, wear seat belt)
- viii. Checking panel board – (Lights and gauges of air pressure, oil pressure, fuel and battery charging.)
- ix. Adjust rear view mirrors and seat

Passed / Failed

(The candidate shall obtain 75% marks (12 out of 16) to be qualified to attend the Part I B test).

**Part I – B Test sheet**

1. Move the vehicle forward and reverse in a 'T' track as shown in the diagram in appendix 'A' of the circular.
2. The vehicle shall be driven in the 'T' track so as to turn both in the right and left directions.
3. While moving in the track the wheels of the vehicle shall not come to complete rest. If the engine stops when the vehicle is inside the track more than once the applicant shall be treated as failed.
4. The driver shall make use of the rear view mirrors and indicator lights during the test.

If suitable ground is not available, the part I B test can be conducted at a limited opening side road at the discretion of test conducting officer.

If the candidate passes Part I B test also, he shall be qualified for road test in Part II.

**Part II Road Test**

The test shall be conducted by the team of officers already prescribed. Special care may be taken to ensure safety of all concerned when the test is conducted, especially Part II road test. For this, suitable road stretch may be identified and notified, where all skills of the driver, such as turning left and right, actions at traffic junctions, pedestrian crossing, changing lanes, skill of overtaking etc. can be tested.

For conducting road test the same 'Checklist' for part II road test specified in Circular No.20/98 shall be used. The following shall be added to the check list

1. The skill for parking the vehicle in to a limited space (Parallel parking).
2. The ability to drive the vehicle upward without rolling backward, after stopping on a gradient road.

This Circular shall come in to force with effect from 01-07-2013. The Deputy Transport Commissioners, Regional Transport Officers and Joint Regional Transport Officers shall place this circular in their Notice Board for the information of all concerned.

Sd/-  
Transport Commissioner

To  
All Deputy Transport Commissioners,  
All Regional Transport Officers,  
All Joint Regional Transport Officers.

Approved for Issue

Senior Deputy Transport Commissioner  
(Taxation)

18/07/13 9/13

cd

APPENDIX A

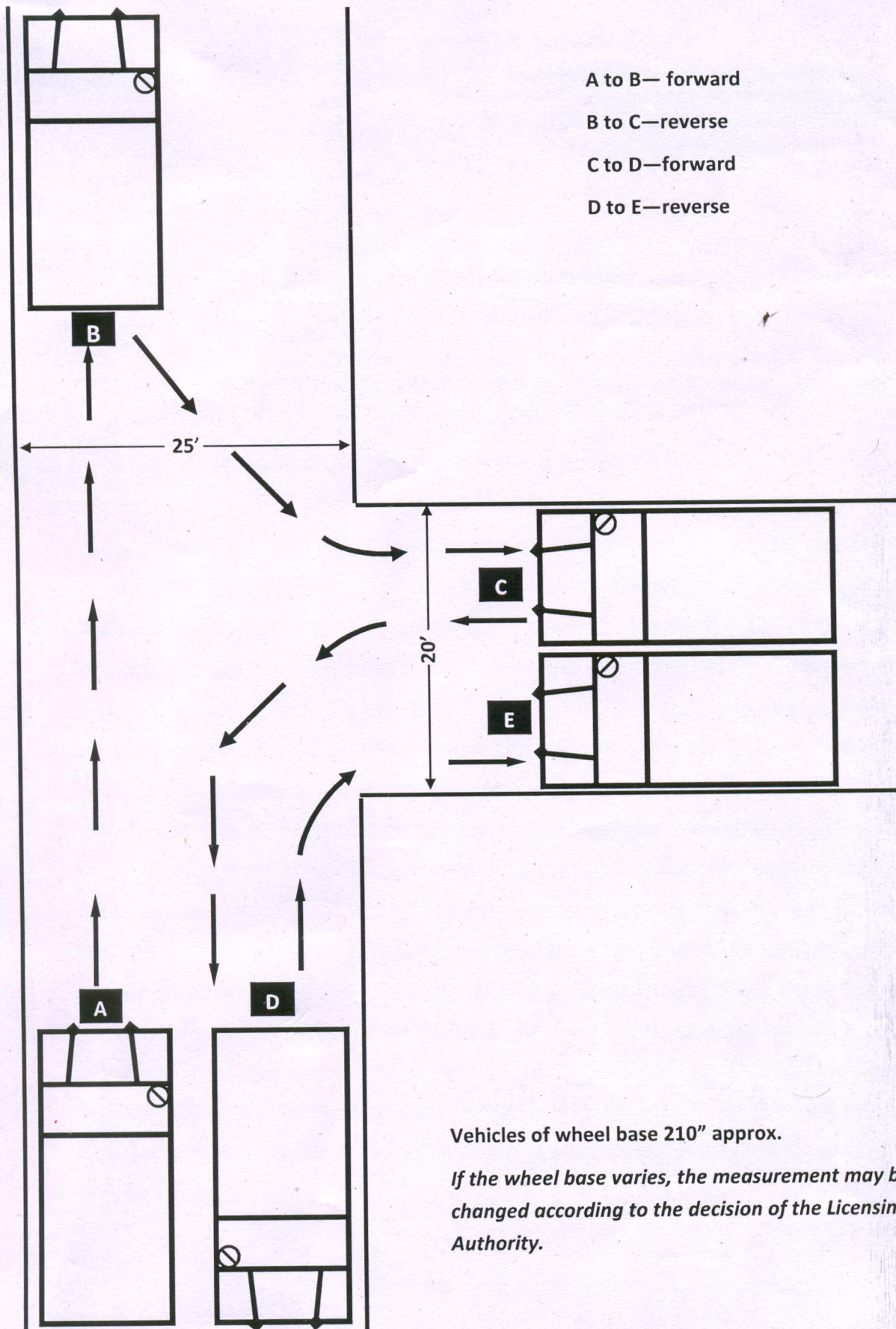

Vehicles of wheel base 210" approx.

*If the wheel base varies, the measurement may be changed according to the decision of the Licensing Authority.*